



CHISAWANI ZONE MOCK EXAMINATION BOARD
2023 PRIMARY SCHOOL LEAVING CERTIFICATE EXAMINATION

MATHEMATICS

(100 marks)

Thursday, 9th March, 2023

Subject Number:

P131

Time allowed: 8:00 –

10:00am

(2hours)

Name of Candidate: _____

(Surname First)

Name of School: _____

Question Number	Tick Questions 21 -29 if answered	Do not write in these columns	
1 - 20			
21			
22			
23			
24			
25			
26			
27			
28			
29			

--	--

Instructions

1. This paper contains 7 pages. Please check
2. This paper has two sections A and B. Section A consists of **20** multiple choice questions carrying 1 mark each. **Encircle** a letter of your choice representing the right answer to each question. Section **B** show your working in the spaces provided. The maximum number of marks for each answer is indicated against the question.
3. Answer **all** questions.
4. In the table provided on this page, tick against the question number you have answered.

5. IMPORTANT

- Please make sure you have written your **name** and **examination number** on the question paper in the spaces provided.
- Hand in your question paper to the invigilator when time is called to stop writing.

© 2023 CZMEB

Turn over

SECTION A(40 MARKS)

1. What is the place value of 9 in the following number 0.4962?

A. Tenth	C. thousandth
B. Hundredth	D. ten thousand
2. Which least number is divisible by 42, 63 and 35?

A. 210	C. 630
B. 420	D. 1260
3. Which one of the following is the prime factor of 81?

A. 81	C. 9
B. 27	D. 3
4. A shop keeper sold two bales of sugar for K34,000. If each bale was bought at K15,000. What was the profit made?

A. K1000	C. K4000
B. K2000	D. K19,000
5. Simplify $18C + 4 - 2c - 1$

A. $16c + 3$	C. $20c - 5$
--------------	--------------

B. $16c + 5$ D. $16c - 3$

6. In a school there are 300 girls and 200 boys. Find the percentage of girls in the school.

A. 67%	C. 33%
B. 40%	D. 60%
7. Find the median of the following numbers 35, 36, 34, 38, 40 and 44

A. 36	C. 34
B. 37	D. 38

Figure 1 shows a simple balance with mass of two different balls A and B. Use it to answer questions 8 and 9

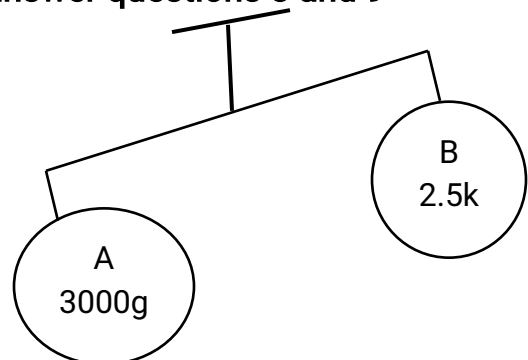

8. What is the mass of the ball B in grams?
 A. 2500g C. 250000g
 B. 250g D. 25000g
9. How many grams should be added to ball B so that it balanced with A?
 A. 250g C. 500g
 B. 700g D. 350g
10. How many decades are there in six human generation?
 A. 10 C. 18
 B. 30 D. 180
11. If 1cm represents 12km. what distance in km will 5.5cm represent?
 A. 2cm C. 6.6cm
 B. 660cm D. 66cm
12. Write the correct symbol inside of the box that will make the inequality $x - 7$ $x - 3$ correct
 A. $>$ C. \leq
 B. \geq D. $<$
13. What is the missing number in the following number pattern (21, 6), (7,20), (11,16), (15,___)?
 A. 16 C. 21
 B. 12 D. 20

Figure 2 is a diagram of a bottle containing paraffin. Use it to answer questions 14 and 15

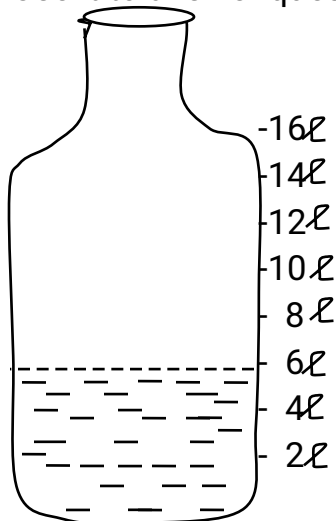

SECTION B (60MARKS)

14. How many more litres of paraffin are needed to fill bottle to the maximum marked level?
 A. 14ℓ C. 12ℓ
 B. 10ℓ D. 22ℓ
15. If the cost of paraffin is K500 per litre. Find the cost of paraffin that is in the bottle
 A. K3000 C. K11000
 B. K5000 D. K7000

Table 1 shows a message send by telegram. Use it to answer question 16

FROM : JANE Box 333 ZOMBA
 SCHOOL CLOSSES NEXT MONTH
 SEND TRANSPORT
 TO : MRS MWALE BOX 1682
 MACHINGA

16. How much was the total cost of sending the telegram at K18 per word?
 A. K360 C. K270
 B. K234 D. K324
17. Solve the equation $\frac{y}{2} + 10 = 80$
 A. 75 C. 30
 B. 140 D. 45
18. The circumference of the base of the basin is 176cm. Find its radius
 A. 56cm C. 42cm
 B. 36cm D. 28cm
19. Which of the following fraction is equivalent to $\frac{2}{5}$?
 A. $\frac{3}{5}$ B. $\frac{10}{15}$ C. $\frac{5}{15}$ D. $\frac{6}{15}$
20. Express $2\frac{1}{3}$ as a decimal number and give your answer to 2 decimal places
 A. 2.03 C. 2.34
 B. 2.01 D. 2.33

21.a) Simplify $3396 + 216 \div 18 \times 22 - 1987$

(4marks)

b) When the number m is reduced by 13, the result is 15. Calculate the number represented by m

(3marks)

22.a) A machine uses 550m of petrol in a minute. If the machine worked for $1\frac{1}{2}$ hours. Calculate the number of litres used

(4marks)

b) The average mass of 13bags of maize is 52.2kg. if 3 bags are sold, the average mass of the remaining bags is 52.7kg. Calculate the total mass of the three bags

(4marks)

23.(a) Figure 3 below shows the floor of a house. Calculate the perimeter of the floor

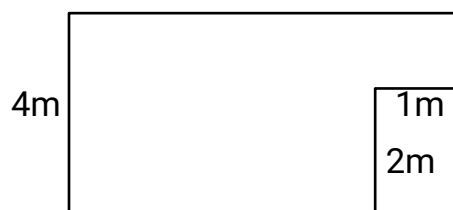

3m

(3marks)

b) What is the cost of building a wall around the floor, if one metre costs K3500.50?

(3marks)

24.a) Using a ruler and a protractor, construct a triangle ABC in which BC = 7cm, angle ABC = 65° and angle ACB = 50°

(4marks)

b) Measure and state the length AC

(1mark)

25. Tina bought a dress at K3500. Zion made a similar dress from 2 metres piece of cloth at K750 per metre, 6 buttons at 3 for K100 and thread for K60. How much did Zion save?

26. Table 2 shows rate of tax on salaries per month for a certain year

Table 2

Salary per month	Rate of tax
First K9000	0% (tax free)
Next K3000	15%
Over K12000	30%

Use the information in table 2 to calculate the monthly tax a worker pays on a monthly salary of K18500

(5marks)

27.a) In a class $\frac{3}{5}$ of the learners put on shoes. If 18 learners do not put on shoes, how many learners are in the class?

(4marks)

b) Figure 4 below shows a wooden door KLMN with a semi-circular glass ABC on it. KL = 22cm, LM = 55cm and AOC = 28cm

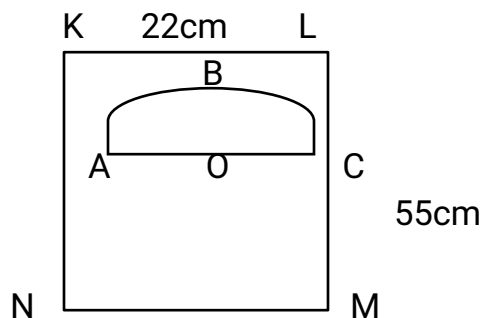

Calculate the area of the wooden part of the door

(5marks)

Table 2 shows the number of tomatoes sold by two vendors at a certain market

Name of Vender	
Mary	○ ○ ○ ○ ○
Ekari	○ ○ ○

28.a) If ○ represent 100 tomatoes. Calculate the difference between the number of tomatoes sold by Mary and those sold by Ekari

(4marks)

b) Simplify the following $11\frac{2}{5} \div 1\frac{7}{12} \times 13\frac{1}{3} + \frac{3}{4} - 1\frac{7}{9}$

(4marks)

29. Mr. Phiri had K25,000.00 at the bank on 4 May 2015. During the month, Mr. Phiri transactions were as follows:

5 May withdraw K4,000.00

7 May bought maize by cheque K3000.00

10 May sold potatoes and banked K4,500.00

20 May sold maize K4,000.00

Prepare Mr. Phiri's bank account and balance it

EXAMINATION NO: _____

END OF QUESTION PAPER
NB: This paper contains 7 pages